

500 line

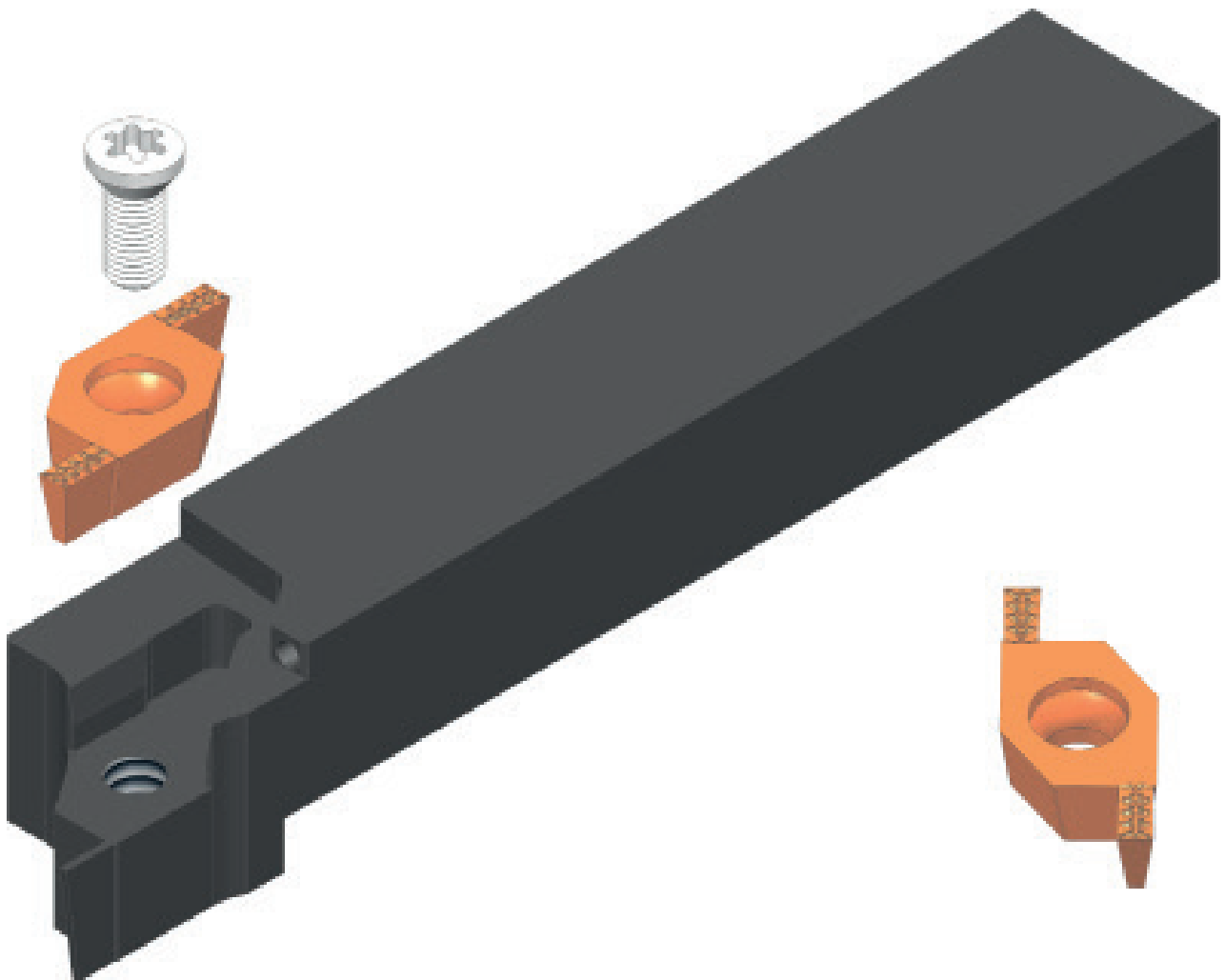

Presentation of 500 line

Presentazione della 500line

Présentation de la 500line

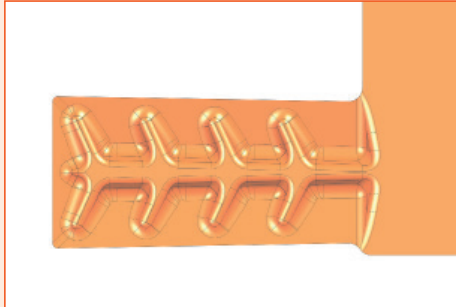

Advantages of the 500line

- Chipbreaker design offering excellent cutting control in steel and stainless steel.
- 2 insert variants available:
 - RYe for roughing and semi-finishing.
 - RY for roughing and finishing.
- Latest-generation coating.

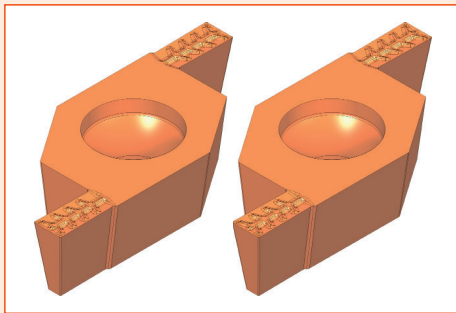

Vantaggi della gamma 500line

- Geometria del rompitruciolo studiata per offrire un eccellente controllo del truciolo su acciaio e acciaio inossidabile.
- 2 varianti di inserto disponibili:
 - RYe per sgrossatura e semifinitura.
 - RY per sgrossatura e finitura.
- Rivestimento di ultima generazione.

BI120
coating

Avantages de la ligne 500line

- Conception de brise-copeau permettant une excellente maîtrise de la coupe dans l'acier et l'acier inox.
- 2 variantes de plaquettes disponibles:
 - RYe pour ébauchage et semi-finition.
 - RY pour ébauchage et finition.
- Revêtement de toute dernière génération.

Coating of inserts

Rivestimento dell'inserto

Revêtement des plaquettes

✓ = Available
 ✓ = Verfügbar
 ✓ = Disponible

Designation Bezeichnung Désignation	Description Beschreibung Description
BI120	<p>AlCrN-based</p> <ul style="list-style-type: none"> • Optimal for cutting edges subject to heavy wear. • Very high heat resistance. • High coating adhesion. <p>Base di AlCrN</p> <ul style="list-style-type: none"> • Ottimale per proteggere il filo tagliente, soggetto a forte usura. • Sehr hohe Hitzebeständigkeit. • Hohe Schichthaftung. <p>Base AlCrN</p> <ul style="list-style-type: none"> • Optimal pour les arêtes de coupe soumises à une forte usure. • Elevatissima resistenza al calore. • Elevata adesione del rivestimento, per lo scivolamento del truciolo.

Insert 500line : cutting data

Inserto 500line : parametri di taglio

Plaquettes 500line : paramètres de coupe

Material Materiale da lavorare Matériau	Cutting speed V_c [m/min] Velocità di taglio V_c [m/min] Vitesse de coupe V_c [m/min]	Feed rate f [mm/rev] Velocità di avanzamento [mm/G] Avance f [mm/tr]
Steel Acciaio Acier	80 – 160	0,1 – 0,2
Stainless steel Acciaio inossidabile Acier inoxydable	50 – 140	0,08 – 0,2
Titanium Leghe di titanio Titane	30 – 80	0,04 – 0,16
Nickel or cobalt alloy NLeghe a base di nichel o cobalto Alliage à base de nickel ou de cobalt	15 – 30	0,02 – 0,1

Field of application of 500line
Campo di applicazione del 500line
Champ d'application de la 500line

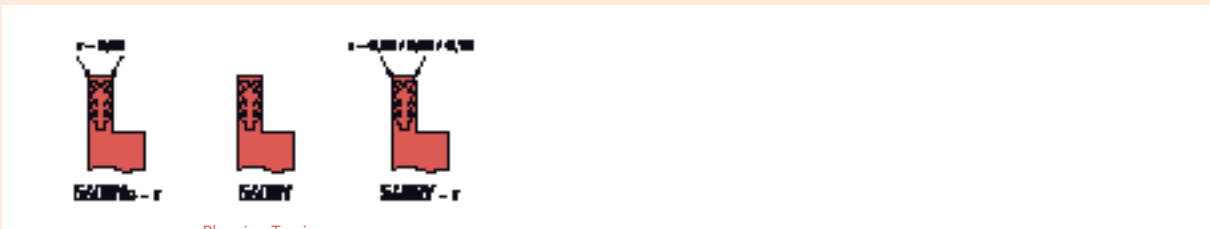
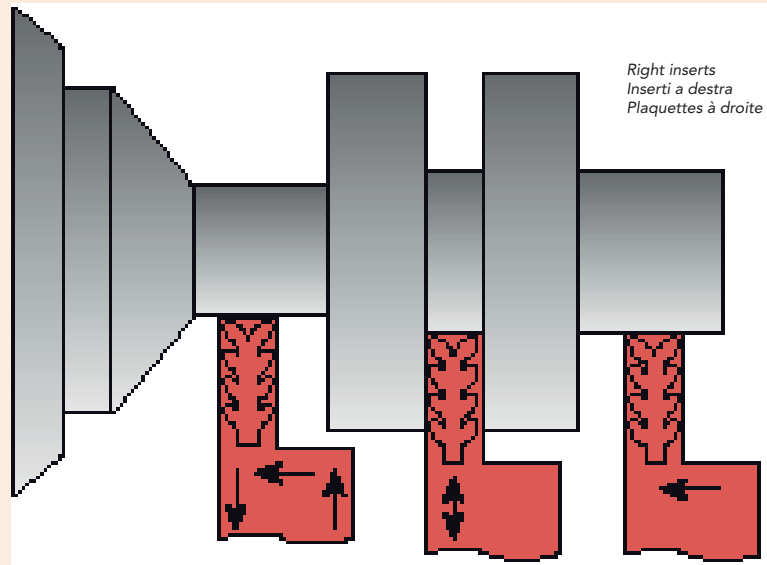

Plunging-Turning
Gole-Tornitura
Fonçage-Tournage

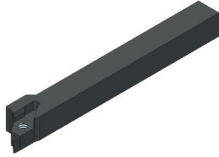
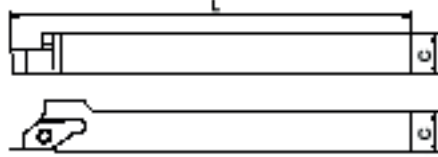
5xxR	Right tool holder Porta-inserti destro Porte-outil à droite	Section C Sezione C Section C	Length L Lunghezza L Longueur L	Article nr. Nr. Articolo N° Article
		8 x 8	120	508R
		10 x 10	120	510R
		12 x 12	120	512R
		16 x 16	120	516R

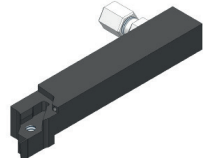
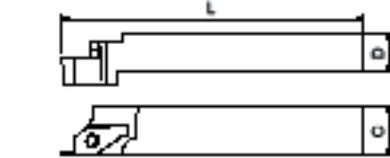
5xxR IK	Right tool holder with internal coolant Porta-inserti destro con refrigerazione interna Porte-outil à droite avec arrosage intégré	Section C x D Sezione C x D Section C x D	Length L Lunghezza L Longueur L	Article nr. Nr. Articolo N° Article
		10 x 16	98	510R IK
		12 x 16	98	512R IK
		16 x 16	98	516R IK

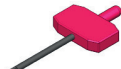
100-1	Key Chiave Clé	Article nr. Nr. Articolo N° Article
	Torx® T15	100-1

100-16	Screw for standard tool holder Vite di ricambio Vis pour porte-outil standard	Article nr. Nr. Articolo N° Article
	M4x10,8 Torx® T15	100-16

**Plunging-Turning
Scanalatura-Tornitura
Fonçage-Tournage**

R : Right machining
R : Utilizzo a destra
R : Usinage à droite

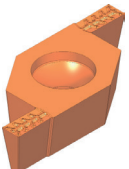
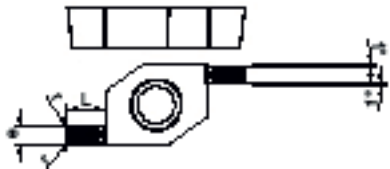
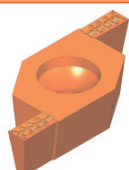
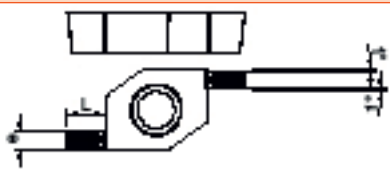
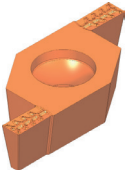
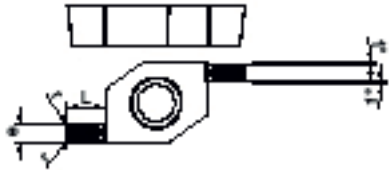
560RYe - r		Inserts with radii for roughing and semi-finishing Inserto raggiato per sgrossatura e semifinitura Plaquettes avec rayons pour ébauchage et de semi-finition			Article nr. Nr. Articolo N° Article	BI120
		e	L	r		
		1,7	3,7	0,08	560RYe1,7 - r0,08 -	✓
		2,2	3,8	0,08	560RYe2,2 - r0,08 -	✓
560RY		Inserts for roughing and finishing Inserto per sgrossatura e finitura Plaquettes d'ébauchage et de finition			Article nr. Nr. Articolo N° Article	BI120
		e	L			
		1,5	4,0		560RY1,5	✓
		2,0	4,0		560RY2,0	✓
560RY - r		Inserts with radii for roughing and finishing Inserto raggiato per sgrossatura e finitura Plaquettes avec rayons pour ébauchage et finition			Article nr. Nr. Articolo N° Article	BI120
		e	L	r		
		1,5	4,0	0,05	560RY1,5 - r0,05 -	✓
		1,5	4,0	0,08	560RY1,5 - r0,08 -	✓
		1,5	4,0	0,15	560RY1,5 - r0,15 -	✓
		2,0	4,0	0,05	560RY2,0 - r0,05 -	✓
		2,0	4,0	0,08	560RY2,0 - r0,08 -	✓
		2,0	4,0	0,15	560RY2,0 - r0,15 -	✓



Represented by Rappresentato da Représentépar

RIDIX

Rappresentanze macchine utensili
Tecnologie per lavorazioni meccaniche